

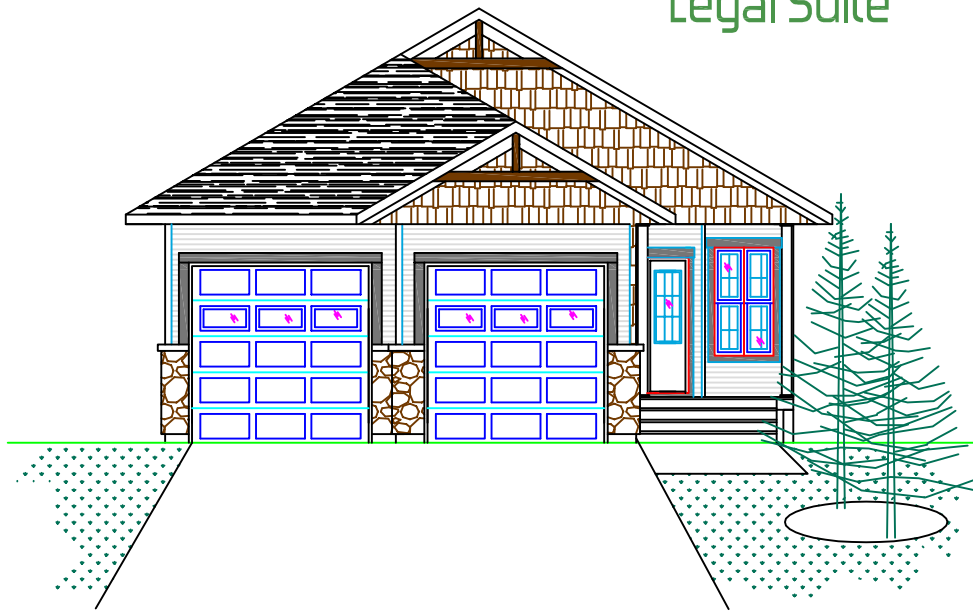

100 Eastpointe Dr
\$335,000

1255 Sqft Bilevel
2 Brm, plus Den,
2Bath, Main laundry
Attached Garage
Legal Suite



Optional legal suite development
\$50,000



www.riserhomes.com
BOX 238, RED DEER, AB - TEL: 403-347-8447 FAX: 403-347-8442 EMAIL: info@riserhomes.com

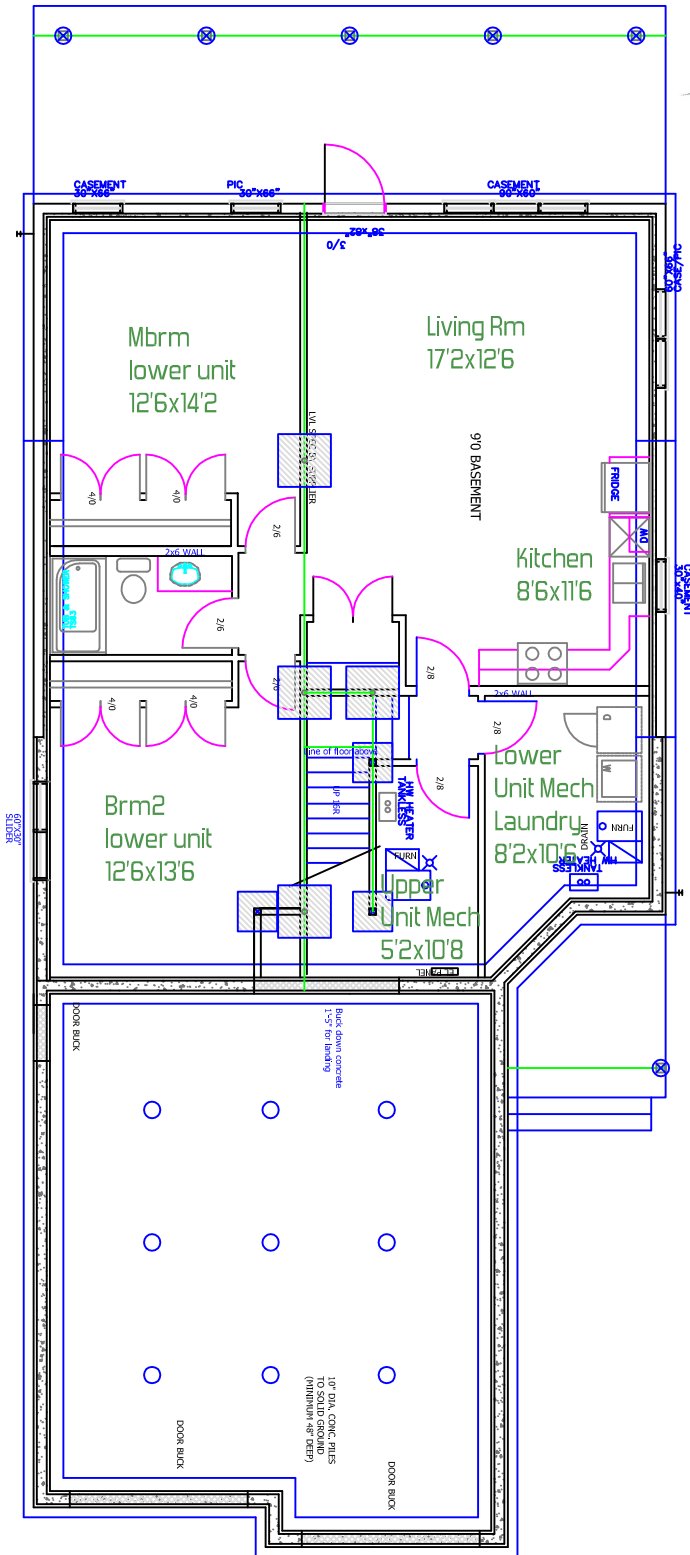

100 Eastpointe Dr Foundation / Optional Legal Suite Floor Plan

1125 Lower Suite
2 Brm, 1 Bath, Private
laundry, Walkout basement
Attached Single Garage





Designed For Living ■ Built For Life

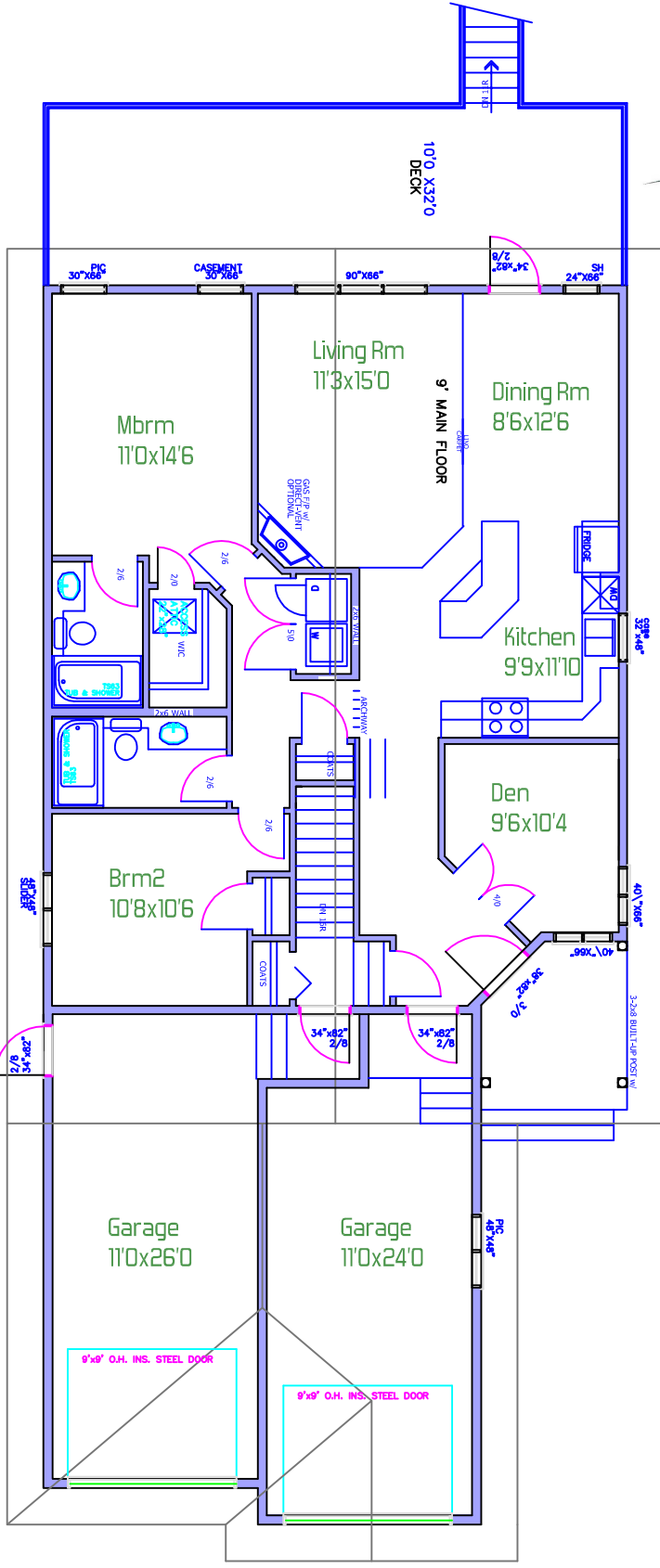

100 Eastpointe Dr Main Floor Plan

1255 Sqft Bilevel
2 Brm, plus Den,
2Bath, Main laundry
Attached Single Garage





100 EASTPOINTE DR

- ✓ **BUILT GREEN**
- ✓ **OPTIONAL LEGAL SUITE**
- ✓ **SINGLE GARAGE FOR EACH UNIT**
- ✓ **2BR+DEN,2 BATH**
- ✓ **MAINFLOOR LAUNDRY**
- ✓ **WALKIN CLOSET IN MASTER**
- ✓ **INSULATED CONCRETE FORM FOUNDATION (TRUE R22)**
- ✓ **FRIDGE/STOVE/DISHWASHER/ OVER THE RANGE MICROWAVE/HOOD FAN**
- ✓ **9' CEILINGS MAIN FLOOR AND BASEMENT**
- ✓ **8 ½ LB UNDERLAY FOR CARPETED AREAS**
- ✓ **EXTENDED EATING BAR**
- ✓ **DECORA LIGHT SWITCHES**
- ✓ **FIREPLACE**
- ✓ **1 CABLE/PHONE IN EACH BEDROOM & LIVING ROOM**
- ✓ **ROUGH-IN VACUUM SYSTEM**
- ✓ **PAINT GRADE INTERIOR FINISH MDF CASINGS**
- ✓ **MDF LOW VOC PAINT GRADE DOORS**
- ✓ **DIGITAL PROGRAMMABLE THERMOSTAT**
- ✓ **R20 BATTS IN WALLS**
- ✓ **R50 BLOWN IN CEILING**
- ✓ **R20 SPRAY FOAMED JOIST ENDS**
- ✓ **95% HIGH EFFICIENT GOODMAN SERIES FURNACE**
- ✓ **ENERGY STAR HIGH EFFICIENT DIRECT VENT HOT WATER HEATER**
- ✓ **INSULATED FIRST 3FT OF HOT WATER LINES**
- ✓ **30 YEAR ARCHITECTURAL SHINGLES**
- ✓ **LOW E ARGON ENERGYSTAR WINDOWS**
- ✓ **CONCRETE DRIVEWAY AND SIDEWALK**
- ✓ **CULTURED STONE ON GARAGE CORNERS**
- ✓ **CONCRETE PATIO AT WALKOUT**
- ✓ **TREATED DECK**
- ✓ **LOT, GST,LEGAL FEES,RPR,INTEREST DURING CONSTRUCTION ALL INCLUDED**
- ✓

\$335,000

OPTIONAL BASEMENT SUITE DEVELOPMENT \$50,000